



City Council
COMMITTEE OF THE WHOLE
City of Belvidere, Illinois

Alderman Clinton Morris, 1st Ward

Alderman Daniel Snow, 2nd Ward

Co-Chairman, City/County Coordinating

Alderman Thomas Ratcliffe, 3rd Ward

Chairman, Finance and Personnel

Vice Chairman Building Planning and Zoning

Alderman George Crawford, 4th Ward

Chairman, Public Safety

Alderman John Sanders, 5th Ward

Chairman, Building, Planning and Zoning

Alderman Clayton Stevens, 1st Ward

Vice Co-Chairman, City/County Coordinating

Alderman Daniel Arevalo 2nd Ward

Vice Chairman, Public Safety

Alderman Wendy Frank, 3rd Ward

Vice Chairman, Finance and Personnel

Alderman Ronald Brooks, 4th Ward

Chairman, Public Works

Alderman Mark Sanderson, 5th Ward

Vice Chairman, Public Works

AGENDA

June 13, 2016

6:00 p.m.

City Council Chambers

401 Whitney Boulevard

Belvidere, Illinois

Call to Order: Mayor Chamberlain

Roll Call: Present: Absent:

Public Comment:

Public Forum:

Reports of Officers, Boards, and Special Committees:

1. Building, Planning & Zoning, Unfinished Business:

A. Northwest Illinois Regional Building Code.

2. Building, Planning & Zoning, New Business: None.
3. Public Works, Unfinished Business: None.
4. Public Works, New Business:
 - A. Primary Digester Rehabilitation Project Update.
 - B. Polymer Feed System Update/Centrifuge Thickener Option –WWTP
 - C. Columbia/Aspen Court Reconstruction Project Update.
 - D. Logan Avenue Engineering Review.
 - E. 2016 MFT Street Overlays – Bid Tabulation.
 - F. State Street Pavement Rehabilitation Project – Bid Tabulation.
 - G. Purchase of State Bid Dump Truck – Street Department.
 - H. Water Survey – Summary of Data.
 - I. Block Party Request – 1704 9th Avenue.
5. Adjournment:

Memo

To: Mayor and City Council
From: Brent Anderson, Director of Public Works
Date: 6/6/2016
Re: Primary Digester Rehabilitation Project Update

The first step of the Digester Rehabilitation Project was to empty and clean the digester. Stewart Spreading was the low bidder to complete this work at a cost of \$39,415.00, based on a quantity of 47,350 gallons of sludge. As it turns out, we actually had 113,974 gallons of heavier sludge that Stewart Spreading had to remove for us. Due to the increased quantity, Stewart Spreading reduced their unit price for the additional 66,624 gallons removed from \$0.70 per gallon to \$0.50 per gallon for a total additional cost of \$33,312.00. To note, even with the additional cost, Stewart Spreading's total bill of \$72,457.00 is still less than the second low bidder's price of \$73,280.00.

Stewart Spreading has completed their work in order to meet the schedule for the general contractor, Leander Construction, on this project.

I would recommend authorization of the additional \$33,312.00 for sludge removal by Stewart Spreading. This additional work will be paid for from the Sewer Equipment Replacement Fund #06-08.

I have attached a few pictures of Stewart Spreading completing their work.





BELVIDERE PUBLIC WORKS

401 Whitney Boulevard

Belvidere, IL 61008

Phone 815-544-9256

Fax: 815-544-4255

Memo

To: Mayor and City Council
From: Brent Anderson, Director of Public Works
Date: June 7, 2016
Re: Thickening Centrifuge Design Engineering

Baxter and Woodman has completed the preliminary engineering on the gravity belt thickener polymer system and has determined that the best option available is to replace the existing gravity belt thickeners with thickening centrifuges. Using a centrifuge in the thickening process is a relatively new application. We replaced our belt filter press with a centrifuge several years ago and it has performed very well. The thickening centrifuges would be from the same manufacturer. Using the thickening centrifuges will eliminate most if not all of the polymer, reduce the space requirement by more than half of the current system, provide a neat and quieter operation as well as increasing our energy efficiency.

Attached is a proposal from Baxter & Woodman to complete the design engineering and bidding documents to complete this project.

I would recommend approval of the proposal from Baxter & Woodman to complete the design engineering for the thickening centrifuges at a cost not-to-exceed \$67,500. This work will be paid for from the Sewer Depreciation Fund.

**CITY OF BELVIDERE, ILLINOIS
WASTEWATER TREATMENT PLANT IMPROVEMENTS -
SLUDGE THICKENING IMPROVEMENTS
DESIGN ENGINEERING SERVICES
WORK ORDER**

ENGINEERS' PROJECT No. 160545.40

Project Description:

The Project consists of removing Gravity Belt Thickener (GBT) No. 2 and providing thickening centrifuges and polymer feed system within the same footprint as the existing GBT's on the north end of the building. The Project also consists of replacing the MCC, HVAC equipment, and Thickened Sludge Pump No. 2 (if needed), along with demolition of obsolete equipment including Piston/Plunger pumps and conveyor. The Project is more specifically described in Attachment A of this Work Order.

Engineering Services:

The general provisions of this contract are enumerated in the Professional Engineering Services Agreement between the City and Engineers dated September 22, 2009. A detailed scope of services for this Project is listed in Attachment B of this Work Order.

Compensation:

Compensation for the services to be provided under this Work Order will be in accordance with the Engineering Services Agreement dated September 22, 2009. The Engineers' fee shall be computed on the basis of their standard hourly billing rates for actual work time performed plus reimbursement of out-of-pocket expenses including travel, which in total amount will not exceed \$67,500.

Submitted by: **Baxter & Woodman, Inc.**

By: _____

Daryl Wald

Title: Vice President

Date: June 7, 2016

Approved by: **City of Belvidere, Illinois**

By: _____

Title: _____

Date: _____

Additional Comments and Conditions: The Project does not include other improvements to the building including doors on the south end of the building or an addition to the west side of the building for vehicular storage.

Project Description

The Project consists of removing GBT No. 2 and providing design and layout for two thickening centrifuges within the same footprint as the GBT on the north end of the Thickener Building at the City's Wastewater Treatment Plant (WWTP). GBT No. 2 was originally installed in 1987 and has been in service since that time. The Project will also include a liquid polymer feed system for the thickening centrifuges, replacing the MCC, HVAC equipment, and Thickened Sludge Pump No. 2 (if needed), along with a demolition plan for removal of obsolete equipment including Piston/Plunger pumps and the conveyor. The design will also consider re-use of existing piping through the GBT area to allow for continued conveyance of sludge to locations further west of the GBT Building.

The Project will consider a phased approach to allow the installation of one or two thickening centrifuges, depending on costs.

The Project does not include modifications to the existing GBT No. 1 or polymer mixing systems, any special funding paperwork such as IEPA, or other improvements to the Thickener Building including doors on the south end of the building or an addition to the west side of the building for vehicular storage.

Scope of Services

The following scope of services details the anticipated tasks necessary to successfully complete this Project.

PRELIMINARY DESIGN SERVICES

1. **PROJECT ADMINISTRATION & MEETINGS** – Confer with the City’s Director of Public Works, and his staff, to clarify and define the general scope, extent, and character of the Project. Plan, schedule, and control the activities that must be performed to complete the Project. These activities include, but are not limited to, budget, schedule, and scope.
2. **DESIGN CONCEPTS**
 - A. **GENERAL**
 1. Obtain and review information relevant to the Project.
 2. Determine general design requirements including applicable codes and permits. Prepare a design criteria summary.
 - B. **PROCESS AND EQUIPMENT**
 1. The thickening centrifuges (2) will be located in the same footprint as GBT No. 2 as discussed at the May 12, 2016 site visit. GBT No. 1 and the existing polymers feed systems will remain in service throughout construction.
 2. The HVAC equipment in the Thickener Building will be replaced.
 3. The MCC in the Thickener Building will be replaced.
 4. The Thickened Sludge Pump No. 2 will be replaced or removed if the space is needed for the thickening centrifuges. Outline demolition requirements for unnecessary equipment including Piston/Plunger pumps and conveyor.
 5. Provide capability of future SCADA system to connect into centrifuge control panels.
 6. Prepare a basis of design and process flow diagram for the sludge thickening process.

3. SITE INFORMATION

- A. EXISTING CONDITIONS/IN-HOUSE REVIEW – Review existing plans and reports.
 - B. TOPOGRAPHIC SURVEY – There will be no topographic survey.
 - C. GEOTECHNICAL SERVICES COORDINATION – There will be no geotechnical investigation for this Project.
 - D. WETLANDS DELINEATION FIELD WORK – There will be no wetland delineation for this Project because it is not expected to impact any wetlands.
 - E. SUBSURFACE UTILITY EXPLORATION COORDINATION – There will be no subsurface utility exploration consultant employed for this Project. The City will provide the horizontal and vertical locations of critical underground utilities (if any) that impact the work.
4. PRELIMINARY DRAWINGS – Prepare preliminary drawings that indicate the proposed thickening centrifuges, polymer feed system locations, and piping replacement in the Thickener Building.
5. PRELIMINARY OPINION OF PROBABLE COST – Prepare a preliminary opinion of the probable total Project cost including construction cost, construction engineering services, contingencies, and, on the basis of information furnished by the City, allowances for legal services, financial consultants, and any administrative services or other costs necessary for completion of the Project.

DETAILED DESIGN SERVICES

1. FINAL DESIGN – Prepare Design Documents consisting of Drawings showing the general scope, extent, and character of construction work to be furnished and performed by the Contractor(s) selected by the City and Specifications, which will be prepared in conformance with the format of the Construction Specification Institute.

2. **CONSTRUCTION DOCUMENTS** – Prepare for review and approval by the City and its legal counsel the forms of Construction Contract Documents consisting of Advertisement for Bids, Bidder Instructions, Bid Form, Agreement, Performance Bond Form, Payment Bond Form, General Conditions, and Supplementary Conditions, where appropriate, based upon documents prepared by the Engineers Joint Contract Document Committee (EJCDC).
3. **AGENCY SUBMITTALS** – Submit the Design Documents to the IEPA for their review and approval for the City to construct and operate the Project, if required.
4. **FINAL OPINION OF PROBABLE COST** – Prepare an opinion of probable construction cost based on the Design Documents.

BIDDING SERVICES

5. **ASSISTANCE DURING BIDDING** – Assist the City in solicitation of construction bids from as many qualified bidders as possible, attend the bid opening and tabulate bid proposals, make an analysis of the bids, and submit recommendations for the award of construction contract.

ESTIMATED MANHOUR AND FEE SUMMARY

Scope Item	Hours	Fee
Preliminary Design Services	185	\$20,750
Detailed Design Services	365	\$40,500
Bidding Services	60	\$6,250
TOTAL ALL SERVICES	610	\$67,500

I:\Crystal Lake\BELVD\160545-Thick Cent Imp\Contract\160545.40 Thickening Centrifuge Work Order_2016-06-06.doc

BELVIDERE PUBLIC WORKS

401 Whitney Boulevard

Belvidere, IL 61008

Phone 815-544-9256

Fax: 815-544-4255

Memo

To: Mayor and City Council
From: Brent Anderson, Director of Public Works
Date: June 7, 2016
Re: Columbia/Aspen Reconstruction Project Update

Work on the Columbia/Aspen Court Reconstruction Project is progressing. To date, all of the sanitary sewer work has been completed. 95% percent of the water system work has been done, including mains, valves, hydrants and services. Work has begun on the storm sewer system improvements. Once the contractor has completed the remainder of the storm sewers, he will then begin the core out for the new roadway pavement.

While working on the water system improvements, it was determined in the field that contrary to our record information, there was no water main located in Walnut Street west of Columbia. Our records indicated that there was a 6" water main, but instead, the contractor found two long services, one on each side of Walnut serving the houses on each side. In order to eliminate the long services, the contractor was advised to install an additional 180 feet of 8" water main in Walnut Street, west of Columbia. The Water Department would then install new services in the right-of-way from the new 8" main to the existing service at the property line. This work will add an extra \$10,000 to \$15,000 to the contract cost for this project.

BELVIDERE PUBLIC WORKS

401 Whitney Boulevard

Belvidere, IL 61008

Phone 815-544-9256

Fax: 815-544-4255

Memo

To: Mayor and City Council
From: Brent Anderson, Director of Public Works
Date: June 6, 2016
Re: Logan Avenue Engineering Review

Logan Avenue was last overlaid in 2000, when we paved Logan, North and South State Street as one project. The pavement surface on Logan is nearing the end of its life cycle and will need attention soon. In addition, as part of any surface rehabilitation, we are required to construct ADA compliant ramps at all intersections. There are other ADA issues that will need to be addressed in the Logan Avenue corridor that have to do with clearances to the existing utility poles. There are multiple areas of crumbling curb along Logan that needs to be addressed as well.

One option to consider for the Logan Avenue corridor going forward would be the "right-sizing" of the pavement cross-section from four lanes to three lanes. Logan Avenue was widened from two lanes to a four lane cross section in the 1950's as part of the Illinois Highway System. When the By-Pass was completed in the early 1990's the majority of the thru traffic on Logan Avenue was eliminated. Traffic volumes on Logan have remained relatively constant since the completion of the By-Pass. A preliminary concept plan for a three lane section on Logan Avenue is attached for reference.

Other options to consider for the Logan Avenue corridor would be:

- Mill and overlay with curb & gutter patching and ADA ramps.
- Mill and overlay with new curb & gutter, ADA ramps and sidewalks.
- Full reconstruction of the existing four lane configuration.

I have received a proposal from Arc Design Resources (copy attached) to complete an alternatives assessment for the options mentioned in this memo for the Logan Avenue corridor in the amount of \$14,900.00.

I would recommend approval of the proposal from Arc Design Resources, in an amount not-to-exceed \$14,900.00, to complete the Logan Avenue Corridor Alternatives Assessment. This work will be paid for from the Public Benefit Fund.



MATCH LINE STATION 114+50
SEE SHEET BELOW



MATCH LINE STATION 129+00
SEE SHEET 02

MATCH LINE STATION 114+50
SEE SHEET ABOVE

FILE NAME C:\Users\jgibson\OneDrive\Documents\Projects\2024\114+50-129+00\114+50-129+00.dwg	USER NAME jgibson	PROJECT MPT	DESIGNED MPT	DRAWN MPT	CHECKED MPT	APPROVED MPT	DATE 02/29/2024	REVISED 0	REVISED 0	REVISED 0	REVISED 0	SECTION 114+50-129+00	COUNTY DAKOTA	SHEET NO. 1	SHEET TOTAL 1
ARC DESIGN SOLUTIONS INC.															
LOGAN AVENUE RIGHT-SIZING PROJECT															



MATCH LINE STATION 129+00
SEE SHEET 01

MATCH LINE STATION 143+00
SEE BELOW

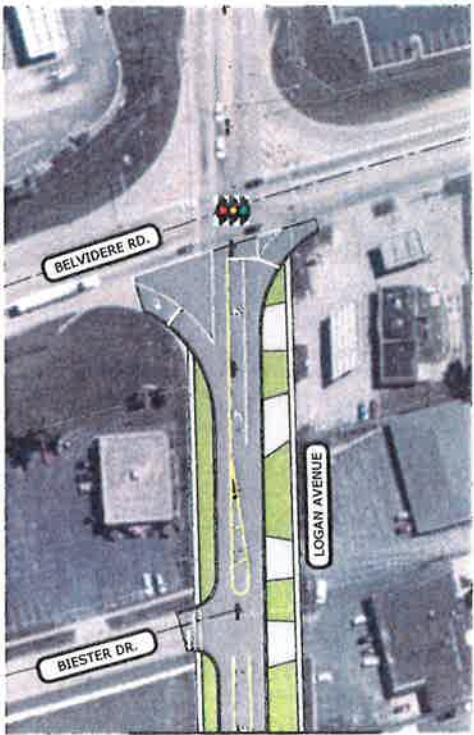

MATCH LINE STATION 143+00
SEE ABOVE

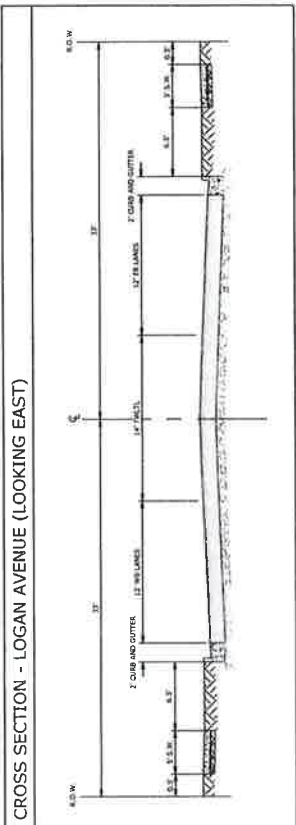

CROSS SECTION - LOGAN AVENUE (LOOKING EAST)

FILE NAME: \\s:\projects\14300\14300.dwg	USER NAME: Marc Trempier	DESIGNED: MFT	REVISION: 01	SECTION: 33-3333-33-33	COUNTY: MOBILE	TOTAL SHEET NO.: 2
PROJECT: Logan Avenue Right-Sizing	PROJECT SCALE: 1" = 50'	DRAWN: MFT	REVISION: 02	DATE: 04/29/2016	CONTRACT NO.: 3333X	SHEET NO.: 2
PROJECT DATE: 04/29/2016	PROJECT: LOGAN AVENUE RIGHT-SIZING PROJECT	CHECKED: JLT	REVISION: 03	ILLUSTRATED BY: PROJECT		

May 9, 2016

Mr. Brent Anderson
City of Belvidere Public Works
401 Whitney Boulevard
Belvidere, IL 61008

**Re: Logan Avenue Corridor
Alternatives Assessment**

Dear Mr. Anderson,

As a resident of Boone County, it is great to see that the City of Belvidere is once again able to move forward with some street projects over the next few years. It has been interesting to discuss the possible options of Logan Avenue with you and we hope that you found the potential "right sizing" concept beneficial in your discussions with City authorities. It is important to understand the long term maintenance costs of any new project, as well as the initial installation costs. To that end, we intend to provide the following scope of services:

- Field assessment of Logan Avenue Corridor from State Street to Belvidere Road.
- Kickoff meeting with public works staff to understand the preliminary costs that have been developed for this corridor.
- Miscellaneous research at County Courthouse for right of way records
- Capacity check for 3-lane and 4-lane pavements based on ADT values.
- Pavement design based on current ADT values and projections
- Cost Options for the following alternatives:
 - Option 1A – Mill and overlay with new curb and gutter and ADA ramps
 - Option 1B – Mill and overlay with new curb and gutter and full sidewalk replacement
 - Option 2 – full reconstruction of existing four lane configuration
 - Option 3 – full reconstruction to a 3-lane "right sizing" configuration
- Summary report and associated exhibits
- Review with public works staff
- Presentation to City Council

Proposed Fee

For the above services, we propose a fee not to exceed \$14,900.00 without your consent and authorization.

Schedule: work will begin upon your authorization to proceed.

If this proposal is acceptable to you, please acknowledge by returning an executed copy of the enclosed standard agreement for engineering services. This proposal is valid for 30 days. Please call if you have in questions regarding the above information.

Sincerely,



Jeffrey S. Linkenheld, P.E.
Project Manager

Encl:

AGREEMENT FOR SERVICES

THIS AGREEMENT FOR ENGINEERING SERVICES is effective this 9th day of May the year 2016, between Arc Design Resources, Inc., hereinafter referred to as ENGINEER of 5291 Zenith Parkway, Loves Park, IL 61111 and City of Belvidere Public Works, hereinafter referred to as the CLIENT for the PROJECT titled Logan Ave Corridor Alternatives Assessment.

The Scope of Services to be provided under this agreement is outlined in the Proposal attached, dated May 9, 2016. The fee for the described services will be calculated on a lump sum fee, not including reimbursable expenses and permit fees for surveying and engineering.

This Agreement For Services, the attached General Conditions, and the Proposal represent the entire and integrated Agreement between the CLIENT and the ENGINEER (The Agreement for Services, the General Conditions and the Proposal are hereafter collectively referred to as the "Agreement") and supersede all prior negotiations, representations or agreements, either written or oral. The Agreement may be amended only by written instrument signed by both CLIENT and ENGINEER.

Arc Design Resources, Inc.

By Joseph R. Altenhoff
Signature

Joseph R. Altenhoff, P.E.

Typed Name

President

Title

City of Belvidere Public Works

Client

401 Whitney Blvd.

Address

Belvidere, IL 61008

Signature

Typed (or printed) name

Title

General Conditions Agreement for Services

Date May 9, 2016
Client City of Belvidere Public Works
Project Logan Avenue Corridor Alternatives Assessment

General Conditions

Responsibilities of Client, Engineer and Contractor

Client's Responsibilities: Client shall be responsible for all requirements and instructions that it furnishes to Engineer pursuant to this Agreement, and for the accuracy and completeness of all programs, reports, data, and other information furnished by Client to Engineer. Engineer may use and rely upon such requirements, programs, instructions, reports, data, and information in performing or furnishing services under this Agreement, subject to any express limitations or reservations applicable to the furnished items. Client shall give prompt written notice to Engineer whenever Client observes or otherwise becomes aware of:

1. any development that affects the scope or time of performance of Engineer's services;
2. the presence at the site of any differing site condition; or
3. any relevant, material defect or nonconformance in:
 - (a) Engineer's services,
 - (b) the construction work,
 - (c) the performance of any construction contractor, or
 - (d) Client's performance of its responsibilities under this Agreement.

With the execution of this Agreement, Engineer and Client shall designate specific individuals to act as Engineer's and Client's representatives with respect to the services to be performed or furnished by Engineer and responsibilities of Client under this Agreement. Such an individual shall have authority to transmit instructions, receive information, and render decisions relative to this Agreement on behalf of the respective party whom the individual represents.

Engineer's Responsibilities: Engineer shall be responsible for the scope of services defined in the accompanying Proposal and further defined in this Agreement for Services. Construction Phase Services, if included in the scope of services, are defined in this Agreement.

Reference Conditions: Engineer is Arc Design Resources, Inc. and will hereinafter be referenced as Arc and the above referenced Client will be referred to as Client. The Project may be hereinafter referenced either as the "Project" or by abbreviation as above set forth.

Subcontracting: Arc shall have the right to subcontract any and all services, duties, and obligations hereunder, in whole or in part, without the consent of Client.

Change Order: The term "Change Order" as used herein is a written order to Arc and signed by Arc and Client, after execution of this Agreement, authorizing a change in the services, including additions or deletions and/or change of prices for such services. Each Change Order shall be considered an amendment to this Agreement. Change orders must be signed by both parties within seven days of the date of the change order to avoid suspension of services.

Severability: The provision of this Agreement shall be severable, and if any clause, sentence, paragraph, provision, or other part hereof shall be adjudged by any court of competent jurisdiction to be invalid, such judgment shall not affect, impair, or invalidate the remainder hereof, which remainder shall continue in full force and effect.

Billings/Payments: Invoices for services shall be submitted at Arc's option either upon completion of such services or on a periodic basis. Invoices shall be payable within 30 days after the invoice date. If the invoice is not paid within 30 days, Arc may, without waiving any claim or right against the Client and without liability whatsoever to the Client, suspend the performance of the services after giving seven days written notice to Client. Retainers shall be credited on the final invoice.

Late Payments: If Client disputes an invoice, either as to amount or entitlement, then Client shall promptly advise Engineer in writing of the specific basis for doing so, may withhold only that portion so disputed, and must pay the undisputed portion subject to the terms outlined in *Billings/Payments* above. Accounts unpaid 30 days after the invoice date may be subject to monthly service charge of 1.50% on the then unpaid balance (18% true annual rate) at the sole election of Arc. In the event any portion or all of an account remains unpaid 90 days after billing, the Client shall pay all costs of collection including reasonable attorney's fees.

Dispute Resolution: Client and Engineer agree to negotiate each dispute between them in good faith during the 30 days after notice of dispute. If negotiations are unsuccessful in resolving the dispute, then the dispute shall be mediated. If mediation is unsuccessful, then the parties may exercise their rights at law.

Waiver: No waiver by either party of any breach, default, or violation of any term, warranty, representation, agreement, covenant, condition, or provision hereof shall constitute a waiver of any subsequent breach, default, or violation of the same or any other term, warranty, representation, agreement, covenant, condition, or provision hereof. All waivers must be in writing.

Force Majeure: Obligations of either party under this Agreement shall be suspended, and such party shall not be liable for damages or other remedies while such party is prevented from complying herewith, in whole or in part, due to contingencies beyond its reasonable control, including, but not limited to strikes, riots, war, fire, acts of God, injunction, compliance with any law, regulation, or order, whether valid or invalid, of the United States of America or any other governmental body or any instrumentality thereof, whether now existing or hereafter created, inability to secure materials or obtain necessary permits, provided, however, the party so prevented from complying with its obligations hereunder shall promptly notify the other party thereof.

Compliance with Law: Arc and Client agree to comply with applicable federal, state, and local laws and ordinances and lawful orders, rules, and regulations of any constituted authority. With respect to design codes, Arc shall perform its services in accordance with the Standard of Care to comply with applicable codes and requirements of any authority having jurisdiction over the Project.

Applicable Law: The validity, performance, and construction of this Agreement shall be governed by and construed according to the laws of the State of Illinois.

Reuse of Documents: All documents including drawings and specifications furnished by Arc pursuant to this Agreement are instruments of its services. They are not intended or represented to be suitable for reuse by Client or others on extensions of this Project, or on any other project. Any reuse without specific written verification or adaptation by Arc will be at Client's sole risk and without liability of Arc, and Client shall indemnify and hold harmless Arc from all claims, damages, losses, and expenses, including attorney's fees, arising out of or resulting therefrom. Any such verification and adaptation will entitle Arc to further compensation at rates to be agreed upon by Client and Arc.

Standard of Care: Services performed by Arc under this Agreement will be conducted in a manner consistent with that level of care and skill ordinarily exercised by members of the profession currently practicing under similar conditions. No other representation expressed or implied, and no warranty or guarantee is included or intended in this Agreement, or in any report, opinion document, or otherwise.

Hazardous or Geotechnical Conditions: The parties acknowledge that Engineer's scope of services does not include any services related to a Hazardous Environmental Condition (the presence of asbestos, PCBs, petroleum, hazardous substances or waste as defined by the Comprehensive Environmental Response, Compensation and Liability Act, 42 U.S.C. §§9601 et seq., or radioactive materials) or Geotechnical Conditions. If Engineer or any other party encounters a Hazardous Environmental Condition, Engineer may, at its option and without liability for consequential or any other damages, suspend performance of services on the portion of the Project affected thereby until Client: (1) retains appropriate specialist consultants or contracts to identify and, as appropriate, abate, remediate, or remove the Hazardous Environmental Condition; and (2) warrants that the Site is in full compliance with applicable Laws and Regulations

Professional Liability:

To the fullest extent permitted by law, the total liability, in the aggregate, of Arc, Arc's officers, directors, partners, employees, agents, and subconsultants, to Client, and anyone claiming by, through, or under Client for any claims, losses, costs, or damages whatsoever arising out of, resulting from or in any way related to this Project or Agreement from any cause or causes, including but not limited to negligence, professional errors and omissions, strict liability, breach of contract, or breach of warranty, shall not exceed the total compensation received by Consultant or \$50,000, whichever is greater.

Opinions of Cost: Since Arc has no control over the cost of labor, materials or equipment, or over a contractor's method of determining prices, or over competitive bidding or market conditions, its opinions of probable project cost or construction cost for this Project will be based solely upon its own experience with construction, but Arc cannot and does not guarantee that proposals, bids, or the construction cost will not vary from its opinions of probable cost. If the Client wishes greater assurance as to the construction cost, it shall employ an independent cost estimator.

Confidentiality: Each party shall retain as confidential all information and data furnished to it by the other party which are designated in writing by such other party as confidential at the time of transmission and are obtained or acquired by the receiving party in connection with this Agreement, and said party shall not reveal such information to any third party.

Indemnification: The Client shall indemnify and hold harmless Arc and all of its personnel from and against any and all claims, damages, losses, and expenses (including reasonable attorney's fees) arising out of or resulting from the performance of the services, provided that any such claim, damage, loss or expense is caused in whole or in part by the negligent act, omission, and/or strict liability of the Client or anyone directly or indirectly employed by the Client (except Arc). Arc shall indemnify and hold harmless the Client and all of its personnel from and against damages, losses and expenses arising out of or resulting from the performance of the services, up to the limit of liability agreed to under the professional liability section of this contract, provided that any such claim, damage, loss, or expense is caused in whole or in part by the negligent act, omission of the Arc or anyone directly or indirectly employed by Arc (Except the Client). In any instance where there is a claim for damages, losses, and expenses resulting from the proven negligent acts of both the Client and Arc then the responsibility shall lie between the Client and Arc in proportion to their contribution of negligence. In no case shall Arc's liability exceed the limit of liability established under the Professional Liability Section of this contract.

Term: Unless sooner terminated or extended as provided herein, this Agreement shall remain in full force and effect from the date first written on the attached proposal letter until the date of completion of the services or either party becomes insolvent, makes an assignment for the benefit of creditors, or a bankruptcy petition is filed by or against it. Either party may terminate this Agreement for cause, due to the material default of the other party, at any time by giving seven (7) working days' written notice of such termination to the other party. Upon such termination of this Agreement, Client shall pay and reimburse Arc for services rendered and costs incurred by Arc prior to the effective date of termination. The indemnification of Arc by Client wherever stated herein shall survive the termination of this Agreement regardless of cause of termination.

Without Representation or Warranty: Arc makes no representation or warranty of any kind, including but not limited to, the warranties of fitness for a particular purpose or merchantability, nor or such warranties to be implied with respect to the data or service furnished. Arc assumes no responsibility with respect to Client's use of the Project.

Subpoenas: The Client is responsible after notification, for payment of time charges and expenses resulting from the required response by Arc to subpoenas issued by any party other than Arc in conjunction with services performed under this Agreement. Charges are based on fee schedules in effect at the time the subpoena is served.

Precedence: These General Conditions shall take precedence over any inconsistent or contradictory provisions contained in any proposal, contract, purchase order, requisition, notice to proceed, or like document regarding Arc's services.

Applicability: These General Conditions, being part of a Professional Service Agreement between the parties above listed, shall by agreement of said parties delete paragraphs that have been crossed out and initialed by both parties as not being applicable to this Project. In all other instances, the parties reaffirm the listed paragraphs in this document.

Fee Schedule: Where lump sum fees have been agreed to between the parties, they shall be so designated in the Agreement attached hereto and by reference made a part hereof. Where fees are based upon hourly charges for services and costs incurred by Arc, they shall be based upon the hourly fee schedule annually adopted by Arc, as more fully set forth in Exhibit A attached hereto and by reference made a part hereof. Such fees in the initial year of this Agreement shall be those represented by Exhibit A, and these fees will annually change at the beginning of each calendar year after the date of this Agreement.

Professional Services With Construction Phase Services

Shop Drawing Review: Client agrees that (1) Arc shall review the contractor's submissions, such as shop drawings, solely for their conformance to information given and the design concept expressed in the documents that Arc issues for construction ("the construction documents"); (2) Arc shall not be responsible for any aspects of a submission that affect or are affected by the means, methods, techniques, sequences, and operations of construction, or safety precautions and programs incidental thereto, all of which are the contractor's responsibility; (3) the contractor will be responsible for lengths, dimensions, elevations, quantities, and coordination of the work with other trades; and (4) the contractor shall be required to review and approve shop drawings and other submittals consistent with this paragraph before submitting them to Arc.

Construction Observation: Services performed by Arc at the construction site will be limited to observation of the contractor's work at reasonable intervals to be agreed with the Client, and providing assistance in interpreting the construction documents. On the basis of the on-site observations, Arc shall keep the Client reasonably informed about the progress and quality of the portion of the construction work completed, and report to the Client (1) known deviations from the construction documents and from the most recent construction schedule submitted by the contractor, and (2) defects and deficiencies observed in the work. Arc shall not have control over, or responsibility for, the acts or omissions of the contractor(s) and is not a guarantor of a contractor's performance. Arc will not be responsible for construction means, methods, techniques, sequences or procedures, or for safety precautions and programs, all of which are the contractor's responsibilities under the construction contract.

Authority and Responsibility: Arc shall have no authority to stop work, shall have no supervision or control as to the work or persons doing the work, shall not have charge of the work, shall not be responsible for safety in, on, or about the job site, or have any control of the safety or adequacy of any equipment, building component, scaffolding, supports, forms, or other work aids, and shall have no duties or responsibilities imposed by the Illinois Structural Work Act, nor shall Arc be responsible for any change to the construction documents made without Arc's written consent. Client warrants that it will make the Contractor aware of its responsibilities as agreed herein and shall write these responsibilities into the contract for construction.

Defective Work:

Arc shall not have authority to reject work, but shall advise Client of work observed that Arc believes, in its professional opinion, to be nonconforming to the construction documents. Arc will provide recommendations to Client regarding whether the contractor should correct such nonconforming work or remove and replace it, or whether Client should consider accepting such work for an appropriate credit, if so provided in the contract for construction.

Professional Services without Construction Phase Services

Client has declined to retain Engineer for Construction Phase Services. Engineer shall not perform shop drawing review, or have any other obligations during the construction of the Project. Client assumes all responsibility for the application and interpretation of the construction documents, review and responses to contractor claims, construction contract administration, processing of contractor change orders and revisions to the construction documents during construction, unless such revisions are due to negligent errors and omissions in the construction documents. Arc shall not be responsible for any revision to the construction documents made without its consent. The Client further assumes all responsibility for construction observation and review, review of contractor's payment applications, and all other necessary construction phase administrative, engineering and professional services. Client waives all claims against the engineer that may be connected in any way to construction phase services.

Exhibit A

**Arc Design Resources Inc.
Hourly Charge Rates
Issued January 1, 2016**

Classification	Current Average Hourly Billing Rates
Admin. Assistant	\$90.00
Technician	\$70.00
Sr. Engineering Technician	\$95.00
Project Engineer	\$95.00
Sr. Survey Technician	\$80.00
Construction Manager	\$85.00
2- Man Field Crew	\$150.00
Assistant Project Manager	\$105.00
Professional Land Surveyor	\$100.00
Project Manager	\$160.00
Principal	\$165.00

Note: The above rates are valid until December 31, 2016.

MEMO

To: Mayor and City Council
From: Brent Anderson, Director of Public Works
Subject: MFT Street Overlay Bid Tabulation
Date: June 1, 2016

The following bids were opened for the 2016 MFT Street Overlay Program:

- | | |
|---|--------------|
| 1. Rock Road Companies
P.O. Box 1779
Janesville, WI 53547 | \$286,842.55 |
| 2. William Charles Construction Co
5290 Nimtz Road
Loves Park, IL 61111 | \$299,746.45 |

The engineer's estimate for this work was \$401,158.50.

I would recommend approval of the low bid from Rock Road Companies, in the amount of \$286,842.55, for the 2016 MFT Street Overlay Program, subject to IDOT approval. This work will be paid for from MFT Funds.

BELVIDERE PUBLIC WORKS

401 Whitney Boulevard

Belvidere, IL 61008

Phone 815-544-9256

Fax: 815-544-4255

Memo

To: Mayor and City Council
From: Brent Anderson, Director of Public Works
Date: June 2, 2016
Re: State Street Overlay Project – Bid Tabulation

The following bids were opened today for the State Street Pavement Rehabilitation Project:

- | | |
|--|--------------|
| 1. Rock Road Companies
P.O. Box 1818
Janesville, WI 53547 | \$279,359.98 |
| 2. William Charles Construction
5290 Nimtz Road
Loves Park, IL 61111 | \$281,764.01 |
| 3. Peter Baker & Son Co
1349 Rockland Road
Lake Bluff, IL 60044 | \$372,687.87 |

The engineer's estimate for this project was \$424,942.00. The current budget includes \$500,000 for the completion of this work.

I would recommend approval of the low bid from Rock Road Companies, in the amount of \$279,359.98, for the State Street Pavement Rehabilitation Project. This work will be paid for from the capital fund.

Memo

To: Mayor and City Council
From: Brent Anderson, Director of Public Works
Date: 6/6/2016
Re: Purchase of 2017 Tandem Axle Dump Truck

The current budget includes \$175,000 in the Capital Fund to purchase a new tandem axle dump truck to replace our 1991 White single axle dump truck. We have received the following pricing for this new vehicle:

CAB & CHASSIS:

Illinois State Bid Contract #PSD4018132

Rush Truck Centers 401 South Dirksen Parkway Springfield, Illinois 62703	2017 International 7400 (2014 Price \$78,194.00)	\$84,236.00
--	---	-------------

DUMP BOX, SNOW PLOW, WING PLOW, SALT SPREADER & CONTROLS:

Bonnell Industries Inc. 1385 Franklin Grove Road Dixon, Illinois 61021	 (2014 Price \$74,559.00)	\$79,985.00
--	----------------------------------	-------------

Total Cost including License/Title \$164,324.00

This truck will be almost identical to the 2014 International 7400 that we purchased from Rush Truck Centers through the State Bid for a cost of \$153,258.00

Rush indicated that they would give the City \$3,000 as a trade-in for our 1991 White single axle dump truck. I believe the truck is worth more than that and request authorization to offer it for sale on ebay.

I would recommend the purchase of a 2017 International 7400 tandem axle dump truck with 15' dump body, snow plow, front-mounted wing plow and salt spreader from Rush Truck Centers for a total cost of \$164,324, in accordance with Illinois State Bid Contract #PSD4016932.

City of Belvidere • Illinois

City Hall: 401 Whitney Blvd.
Belvidere, Illinois 61008-3710
(815) 544-2612 • Fax (815) 544-3060

BLOCK PARTY REQUEST FORM Street Closure Required

Requested by: Jonan S. Sierra
Address: 1704 9th ave Belvidere IL
Date of Block Party: July 16th
Time of Block Party: 10AM - 6PM
Estimated number of
Individuals participating: 100

Description of Planned
Activities:

Bouncy houses, cook out, Bag-oh, Kid games
water games

Will block the entrance of 9th Ave and the
corner of 10th st and 10th Ave (Not blocking 10th st)
Between w 10th and w 12th st.

The undersigned hereby acknowledges, understands and agrees to the following: If this request is authorized by the Belvidere City Council it is the responsibility of participants to place from and return street barricades to the terrace.

Furthermore, section 10-40 of the Belvidere Code of Ordinances prohibits use of alcoholic liquor on any public street or sidewalk. This ordinance states "it shall be unlawful to any person to consume alcoholic liquor or to have any alcoholic liquor in his possession...on any public street, sidewalk, etc." This ordinance applies to block parties.

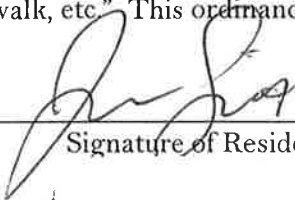
Signature of Resident

5/25/16
Date

Belvidere Police Department



Jan W. Noble – Chief of Police

Tony Martin – Deputy Chief, Administration

Shane Woody – Deputy Chief, Operations

615 N. Main Street - Belvidere, IL 61008 - Phone 815-544-9626 - Fax 815-544-9603 - www.ci.belvidere.il.us

Date: June 7, 2016

Contact Person: Chief Jan W. Noble (815) 544-9626

For Immediate Release:

Please join us on Wednesday June 8th, 2016 at 1:00 PM, at the intersection of Highline Drive and Christi Lane, where we will begin our Summer Community Policing Outreach Initiative. The Belvidere Police Department will be showcasing our new city soccer park and our new Community Policing Coordinator, Officer Tim Blankenship.

A Belvidere P.D. officer will be at the soccer park every Monday, Wednesday, and Friday 9:00 AM-12:00 PM and 1:00 PM- 4:00 PM, from June 8-August 8, with the exception of July 4th and inclement weather days. Our officers will hand out crime prevention materials and discuss community policing programs with area residents. Kids will receive free ice cream on Friday afternoons, along with other giveaways throughout the week.

Other participants include the Belvidere Fire Department, The Belvidere YMCA, the Belvidere Park District, the Boone County Conservation District, the Boone County Health Department and the Rockford YWCA.

We would like to especially acknowledge General Mills, Dean Foods, Berg Industries, Boone County Crime Stoppers and the Byron Bank, for their donations and assistance with this park and our summer program.

FOR INFORMATION ONLY



Monday, April 18, 2016

Dear Utilities, Thank you for participating in our water and sewer rate survey this year. There were over 400 participating utilities from all over the State of Illinois who sent in their data. From small rural systems, subdivisions, medium cities and large metropolitan Cities. Thank you all! Many of the surveys gave complex details about the rate structures and it was a challenge to fit the data into a model that everyone could use, but we managed to input the data into our sheet. Please notify us if you see an error on your rates. This project is supported by the City of Carbondale and the OPTIONS Transitions to Independence Program, Internship Program; an OPTIONS intern completed this project while learning job skills and technical expertise on Excel spreadsheets to gain valuable vocational skills. This year we are proud of Sarah, who has spent the last six months working on this survey. We hope you find the information beneficial!

Thank you, Kimberly Cole Phone 618.457.8613 ext 223 email: kcoble@ci.carbondale.il.us

Summary of data:

	Minimum Water Bill	Minimum Sewer Bill	Water Bill for 6000 Gallons	Sewer Bill for 6000 Gallons	Total Bill for Water and Sewer	Do you expect a rate increase?	Number of Connections
Average	\$21.04	\$15.92	\$43.01	\$31.34	\$65.64	No 47%	2,237
Highest	\$135.75	\$85.75	\$150.75	\$99.05	\$204.00	Yes 53%	54,000

Belvidere \$6.50 \$6.50 \$12.59 \$19.73 \$32.32

	Charge for a 3/4" Short Tap	Charge for a 3/4" Tap by Bore Road Crossing	Do you charge by Flat Fee or Time and Materials?	Does your system disconnect water for non-payment?	Minimum outstanding monthly bill before disconnection	Minimum outstanding bill (in days) before disconnection	Reconnect fee
Average	\$1,001.00	\$1,614.00	Flat fee 54%	No 3%	\$90	30 days	\$57.09
Highest	\$15,000.00	\$28,000.00	Time and Materials 16%	Yes 97%	\$400	180 days	\$650.00

Community Water Supply	Minimum Water Bill	Minimum Sewer Bill	gk gal Water	gk gal Sewer	Total Water and Sewer	Number of service connections	Raise increase expected	Do you disconnect for non-payment?	Minimum Outstanding bill \$	Minimum Outstanding bill in days	Reconnect charge	Short tap for 3/4 inch	Bore road crossing for 3/4 inch	For the tap, do you charge a "flat fee" or "time & materials"?	Comments
ABS Water Cooperative	\$28.00	\$55.00	\$55.00	\$29.75	\$84.75	2,700	Yes	Yes	15 days	\$50.00	\$800.00	flat fee	meter connects charge is \$900 which pays for parts such as meter, pit, lid, remote and saddle. Customer pay plumber direct for installation, road bore and tapping		
Abbeville	\$15.00	\$12.00	\$40.00	\$29.75	\$69.75	1,400	Yes	Yes	60 days	\$100.00	\$100.00	flat fee	No charge		
Alexis	\$36.07	\$15.28	\$38.29	\$31.64	\$69.93	1,733	Yes	Yes	60 days	\$15.00	\$100.00	flat fee	Customer is responsible to hire a licensed drain layer. Industrial sewer \$500		
Alpharetta	\$26.07	\$26.07	\$66.07	\$66.07	\$132.14	400	Yes	Yes	45 days	\$65.00	\$7,800.00	flat fee	Connect fee avg \$7,800 and meter \$505.00. Varies with the number of bedrooms. Simple run across highway ext. flat fee of \$750 plus time and materials.		
Alpharetta	\$12.00	\$12.00	\$24.00	\$22.86	\$46.86	11,000	Yes	Yes	60 days	\$100.00	\$100.00	flat fee	None		
Alpharetta	\$12.00	\$12.00	\$26.16	\$16.62	\$42.78	320	Yes	Yes	45 days	\$25.00	\$100.00	flat fee	None		
Alpharetta	\$14.00	\$52.02	\$54.00	\$59.28	\$113.28	1,200	Yes	Yes	30 days	\$25.00	\$650.00	flat fee	None		
Alpharetta	\$32.00	\$79.10	\$79.10	\$90.10	\$169.20	469	Yes	Yes	60 days	\$25.00	\$500.00	flat fee	None		
Anchor	\$30.00	\$50.00	\$50.00	\$75.00	\$125.00	75	Yes	No	7 days	\$50.00	\$500.00	flat fee	None		
Anna	\$21.25	\$12.06	\$50.42	\$28.06	\$78.48	2,187	Yes	Yes	7 days	\$50.00	\$350 plus costs	flat fee	Road bore is \$350 plus cost		
Anna	\$21.25	\$24.65	\$24.65	\$24.34	\$48.99	201	Yes	No	20 days	\$50.00	n/a	n/a	n/a		
Anneaux	\$11.50	\$11.50	\$24.34	\$24.34	\$48.68	430	Yes	Yes	21st of month	\$30.00	\$500.00	flat fee	Owner pays for everything including all materials, plumber, backhoe \$30 per hour labor / cost of material for bore road crossing \$28.00 hr material depends on job		
Arcola	\$10.75	\$4.45	\$50.25	\$26.70	\$76.95	1,280	Yes	Yes	10 days	\$25.00	\$500.00	flat fee	Licensed plumber		
Ashley	\$15.50	\$1.00	\$73.00	\$17.00	\$90.00	304	Yes	Yes	60 days	\$30.00	\$500.00	flat fee	Depends on our cost		
Ashmore	\$39.50	\$59.50	\$59.50	\$59.50	\$119.00	347	Yes	Yes	60 days	\$75.00	\$500.00	flat fee	The customer pays for his or her own installation. Hourly for time and materials		
Ashmore	\$19.80	\$19.85	\$19.85	\$33.85	\$53.65	420	Yes	Yes	85 days	\$25.00	\$1,500.00	flat fee	For sewer, it's paid bi-monthly.		
Athens	\$24.45	\$23.20	\$40.88	\$49.52	\$90.35	1,600	Yes	Yes	30 days	\$25.00	\$50.25	flat fee	Connection fee \$1,118.00		
Aurora	\$12.65	\$17.65	\$30.88	\$7.62	\$38.50	48,700	Yes	Yes	30 days	\$50.00	\$120.00	flat fee	For road crossing it's contracted out.		
Ava	\$13.40	\$12.50	\$33.02	\$22.60	\$55.62	532	Yes	Yes	30 days	\$50.00	\$800.00	flat fee	Non-residential water is only \$16.53		
Berwyn	\$6.00	\$15.50	\$45.00	\$24.00	\$69.00	273	Yes	Yes	60 days	\$50.00	\$500.00	flat fee	We charge only for the tap and their contractor bills the customer directly.		
Berkeley	\$13.43	\$7.53	\$56.58	\$8.10	\$64.68	1,787	Yes	Yes	25 days	\$100.00	\$65.00	flat fee	No additional fee for road crossing		
Bethany	\$12.19	\$7.23	\$5.14	\$11.18	\$68.32	6,300	Yes	Yes	60 days	\$65.00	\$2,000.00	flat fee			
Bethany	\$6.05	\$8.98	\$28.25	\$7.84	\$36.09	616	Yes	Yes	30 days	\$25.00	\$100.00	flat fee			
Blairville	\$14.00	\$14.00	\$45.00	\$45.00	\$90.00	324	Yes	Yes	90 days	\$25.00	\$100.00	flat fee			
Bloomington	\$39.60	\$22.30	\$47.52	\$26.76	\$74.28	7,281	Yes	Yes	41 days	\$50 or \$120	\$11,740.00	flat fee			
Bloomington Township	\$20.90	\$11.84	\$68.80	\$38.72	\$107.52	501	Yes	Yes	60 days	\$50.00	\$1,530.00	flat fee			
Blue Mount	\$6.00	\$10.05	\$33.00	\$34.05	\$67.05	901	Yes	Yes	60 days	\$25.00	\$150.00	flat fee			
Blufford	\$17.02	\$15.91	\$40.84	\$27.51	\$68.35	705	Yes	Yes	60 to 90 days	\$500.00	\$150.00	flat fee			
Bond Masfison	\$11.64	\$16.28	\$37.04	\$25.88	\$62.92	224	Yes	Yes	32 days	\$25.00	\$750.00	flat fee			
Bowen	\$11.25	\$40.40	\$17.25	\$46.70	\$63.95	229	Yes	Yes	10 days	\$50.00	\$100.00	flat fee			
Boynton	\$24.00	\$59.00	\$59.00	\$42.33	\$101.33	330	Yes	Yes	60 days	\$100.00	\$1,500.00	flat fee			
Braceville	\$13.38	\$42.33	\$13.98	\$42.33	\$56.31	320	Yes	Yes	90 days	\$50.00	\$500.00	flat fee			
Braceville	\$11.57	\$3.04	\$41.27	\$18.24	\$59.51	2,300	Yes	Yes	10th per month	\$25.00	\$500.00	flat fee			
Brimfield	\$17.85	\$8.74	\$53.53	\$13.24	\$66.77	345	Yes	Yes	30 days	\$100.00	\$110.00	flat fee			
Brussels	\$13.20	\$1.62	\$52.83	\$6.50	\$59.43	2,926	Yes	Yes	15 days	\$100.00	\$1,000.00	flat fee			
Brookfield North Riverside	\$4.84	\$28.00	\$28.00	\$29.00	\$57.00	9	Yes	No	30 days	\$50.00	\$1,000.00	flat fee			
Brookport	\$21.63	\$21.81	\$67.68	\$43.26	\$110.94	409	Yes	Yes	30 days	\$50.00	\$1,390.00	flat fee			
Browning	\$30.00	\$11.98	\$59.53	\$54.56	\$114.09	76	Yes	Yes	30 days	\$25.00	\$250.00	flat fee			
Browning	\$11.98	\$20.81	\$59.53	\$54.56	\$114.09	403	Yes	Yes	30 days	\$25.00	\$300.00	flat fee			
Bruceville	\$38.00	\$46.25	\$46.25	\$46.25	\$92.50	110	Yes	No	90 days	\$10.00	\$600.00	flat fee			
Brunswick	\$114.40	\$114.40	\$114.40	\$114.40	\$228.80	398	Yes	Yes	30 + days	\$100.00	\$2,000.00	flat fee			
Burford	\$39.50	\$49.50	\$49.50	\$49.50	\$99.00	225	Yes	Yes	60 days	\$100.00	\$500.00	flat fee			
Burnside	\$20.00	\$60.00	\$60.00	\$60.00	\$120.00	1,000	Yes	Yes	60 days	\$50.00	\$1,150.00	flat fee			
Calhoun County	\$28.00	\$76.00	\$76.00	\$76.00	\$152.00	1,112	Yes	Yes	15 days	\$100.00	\$1,000.00	flat fee			
Cambria	\$19.06	\$16.15	\$50.42	\$36.03	\$86.45	692	Yes	Yes	30 days	\$50.00	\$45.00	flat fee			
Camp Point	\$10.00	\$24.00	\$24.00	\$24.00	\$48.00	523	Yes	Yes	15 days	\$20.00	\$45.00	flat fee			
Campbell Hill	\$10.50	\$6.50	\$26.50	\$17.50	\$44.00	256	Yes	Yes	90 days	\$195.00	\$500.00	flat fee			
Canton	\$6.50	\$6.50	\$48.61	\$36.58	\$85.19	5,800	Yes	Yes	30 days	\$50.00	\$262.05	flat fee			
Carbon Cliff	\$7.24	\$81.15	\$77.24	\$81.15	\$158.49	630	Yes	Yes	90 days	\$30.00	\$650.00	flat fee			
Carbon Hill	\$37.76	\$57.90	\$57.90	\$57.90	\$115.80	156	Yes	Yes	75 days	\$40.00	\$40.00	flat fee			
Carrollville	\$3.76	\$5.03	\$28.26	\$41.03	\$70.29	7,830	Yes	Yes	30 days	\$25.00	\$700.00	flat fee			

\$25 are for both reconnection fees and add to deposit. For road crossing it's \$450 for water tap and \$25 for deposit. 3/4 inch tap charge varies between flat fee and time and materials. Flat fee 1 month bill - 2 weeks after due date.

Community Water Supply	Minimum Water Bill	Minimum Sewer Bill	5K gal Water	5K gal Sewer	Total Water and Sewer	Number of service connections	Rate increase expected	Do you disconnect for non-payment?	Minimum Outstanding bill \$	Minimum Outstanding bill in days	Reconnect charge	Short tap for 3/4 inch	Bore road crossing for 3/4 inch	For the tap, do you charge a "flat fee" or "time & materials"?	Comments
Parr-Bron	\$27.00	\$32.00	\$44.50	\$46.00	\$90.50	520	no	yes		90 days	\$50.00	\$400.00		flat fee	For non payment if the water is either turned on or off it will be \$65. The total will be \$130
Paschimond	\$38.60	\$38.60	\$19.92	\$21.89	\$41.81	785	yes	yes		30 days	\$130.00	\$5,653.34		flat fee	
Raleigh	\$25.00		\$30.00		\$30.00	270	no	yes		60 days	\$50.00	\$750.00	\$5.00 per foot	flat fee	1" is \$1,750 and 2" \$3,500. Each includes meter, check valve, curb stop, fittings and equip. The timeframe is still 30 days from the first bill. (We send out a 2nd notice if bill is not paid the 1st time.)
Ranoke	\$14.01	\$6.70	\$57.01	\$14.95	\$71.96	885	yes	yes		30 days	\$60.00			flat fee	
Rapids City	\$25.00	\$35.00	\$33.60	\$58.00	\$91.60	432	no	yes		60 days	\$150.00	\$400.00		flat fee	
River Forest	\$20.68	\$12.43	\$47.32	\$28.47	\$75.79	3,110	yes	yes		5 days	\$100.00	\$500.00	\$300.00	flat fee	
Robbins	\$31.46	\$22.75	\$63.65	\$22.75	\$86.40	1,288	yes	yes	\$200.00	45 days	\$50.00	\$350.00		flat fee	
Roberts	\$40.00		\$62.00		\$62.00	195	no	yes	\$60.00	60 days	\$60.00			flat fee	The village takes the responsibility of the cost for installing water not the customer.
Rock City	\$9.23	\$11.00	\$15.00	\$11.00	\$26.00	128	yes	yes		90 days	\$40.00			flat fee	
Rockford	\$32.00	\$27.32	\$27.32	\$27.32	\$54.64	50,600	yes	yes	\$20.00	51 days	\$75.00	\$4,535.00		flat fee	
Rosendale	\$20.00	\$15.50	\$28.45	\$33.00	\$61.45	521	no	yes		30 days	\$50.00			flat fee	
Roxville	\$10.00	\$1.50	\$21.50	\$44.80	\$66.30	616	no	yes		5 days	\$25.00	\$300.00		flat fee	
Roxton	\$10.80	\$11.65	\$35.09	\$26.10	\$61.19	536	yes	yes		60 days	\$30.00	\$350.00		flat fee	
Royal Woburn	\$27.00		\$50.00		\$50.00	740	no	no	\$100.00	90 days	\$250.00	\$1,500.00		flat fee	
Sandoval	\$15.68	\$6.89	\$45.19	\$31.29	\$76.47	574	yes	yes	\$100.00		\$50.00	\$600.00		flat fee	If the bill is past due then it will take 90 days to repay it or the water will be turned off until the next bill is sent out.
Sandwich	\$5.00	\$5.00	\$16.80	\$38.40	\$55.20	2,840	yes	yes		30 days	\$50.00			flat fee	
Schaumburg	\$3.40	\$63.26	\$10.32	\$63.58	\$73.98	26,048	yes	yes	\$30.00	45 days	\$50.00	\$240.00		flat fee	For non-payment it's both \$10 when water is turned off and on.
Schram City	\$18.00	\$20.00	\$50.00	\$57.50	\$107.50	302	no	yes		30 days	\$10.00	\$400.00		flat fee	
Stanton	\$48.00	\$80.00	\$45.00	\$80.00	\$125.00	96	yes	yes		60 days	\$30.00			flat fee	
Seneca	\$12.94	\$16.89	\$45.34	\$35.74	\$81.08	894	yes	yes		30 days	\$25.00		\$1,000.00	flat fee	For non-payment \$25 1st time, \$50 2nd time and \$100 3rd time. For road crossing it's the cost of the contractor.
Sesser	\$10.65	\$11.14	\$23.65	\$20.94	\$44.59	1,151	yes	yes	\$50.00	35 days		\$600.00		flat fee	Payment is \$50 for the first time and \$100 the second time. For short tap it's \$100.00 for water and sewer.
Shelbyville	\$11.06	\$12.25	\$29.96	\$22.65	\$52.61	2,800	yes	yes		60 days	\$100.00			flat fee	\$75 normal hours and \$150 after hours
Shorewood	\$3.47	\$11.98	\$28.67	\$42.09	\$70.76	6,051	yes	yes		45 days	\$4,334.00			flat fee	\$1,000 + materials
SJM Water Comm.	\$16.75					155	no	yes		90 days	\$50.00			flat fee	For road crossing it's \$1,000 to \$2,000. We also just raised the monthly rate in the beginning of the year.
Snake Trail	\$34.00		\$42.00		\$42.00	47	no	yes		60 days	\$300.00			flat fee	\$36 tap fee or customer must pay contractor
Somerset	\$23.45	\$26.55	\$40.58	\$41.54	\$82.12	761	yes	yes		45 days	\$75.00			flat fee	For non-payment it's \$15 when the water is turned on and \$15 again when the water is turned off which is \$30 all together.
Sorrento	\$35.50	\$15.00	\$85.75	\$25.00	\$110.75	250	no	yes		30 days	\$30.00	\$400.00		flat fee	For short tap \$1,000 prepaid installation charge. For road crossing, flat fee, time and materials charges are prepared by contractor.
South Highway	\$16.25		\$45.00		\$45.00	1,951	yes	yes	\$16.25	60 days	\$75.00	\$600.00		flat fee	Not sure about short tap or bore prices
South Lawrence	\$32.00		\$67.00		\$67.00	443	no	yes		10 days	\$100.00	\$1,600.00		flat fee	
South Wilmington	\$20.00		\$65.23		\$65.23	320	yes	yes		30 days	\$100.00			flat fee	
Southwater	\$25.00		\$73.95		\$73.95	895	no	yes		60 days	\$50.00	\$1,400.00	\$2,500.00	flat fee	
Sparta	\$28.76	\$7.35	\$27.61	\$21.20	\$58.81	2,021	yes	yes	\$25.00	46 days	\$25.00	\$600.00	\$250.00	flat fee	We only do water not sewer. For short tap water it's \$60 plus sidewalk repair costs.
Springfield	\$16.06		\$37.17		\$37.17	54,000	no	yes		10 days	\$75.00			flat fee	Flat fee + materials. We do not install water lines, this is done by an outside contractor.
St. David	\$38.00	\$16.00	\$83.00	\$43.00	\$126.00	528	no	yes		10 days	\$50.00	\$500.00		flat fee	For non payment \$25 the first time, \$50 the second time and \$75 the third time
St. Elmo	\$8.75	\$11.66	\$17.35	\$33.25	\$44.60	650	no	yes		27 days	\$75.00	\$450.00		flat fee	For flat fee \$31 in town, \$50 out of town also known as water tap on and \$35 for sewer tap on.
St. Francisville	\$10.60	\$7.00	\$31.80	\$7.00	\$38.80	320	no	yes		30 days	\$50.00	\$156.00		flat fee	Flat fee any extra charges over \$1500. For number of service connections it's 1.06 for water and 1.70 for sewer.
St. Jacob	\$17.52	\$8.60	\$53.92	\$22.80	\$76.72	720	no	yes		30 days	\$25.00	\$31.00		flat fee	
St. Paver	\$20.75	\$49.53	\$55.65	\$48.53	\$104.28	188	no	yes		10 days	\$50.00	\$1,500.00		flat fee	
Standard	\$60.00		\$60.00		\$60.00	129	no	yes		10 days	\$100.00			flat fee	
Stateville	\$20.11	\$11.24	\$33.95	\$18.16	\$52.11	956	yes	yes		40 days	\$50.00	\$175.00		flat fee	Short tap fee \$175+repair costs including employee's salary
Stateville	\$0.75	\$0.75	\$63.00	\$87.00	\$150.00	46	no	yes		90 days	\$0.00	\$250.00		flat fee	Min Water and Sewer is \$0.75 per gallon. Water includes \$18 OIL, Sewer includes \$43 OIL.
Stockton	\$24.45	\$14.73	\$44.45	\$54.73	\$99.18	900	yes	yes		60 days	\$50.00	\$1,000.00		flat fee	
Stuesburg	\$27.57	\$17.84	\$45.60	\$24.12	\$69.72	254	no	yes		30 days	\$50.00			flat fee	
Stronghurst	\$10.00	\$19.44	\$18.00	\$26.32	\$44.32	395	no	yes		14 days	\$300.00	\$300.00		flat fee	
Sublette		\$28.80			\$28.80	205	yes	yes		30 days	\$50.00	\$1,000.00		flat fee	
Sumner	\$17.64	\$9.35	\$50.64	\$27.00	\$77.64	474	no	yes	\$20.00	30 days	\$75.00	\$900.00		flat fee	
Tampaco	\$30.90	\$32.45	\$38.70	\$42.05	\$80.75	320	no	yes		45 days	\$20.00			flat fee	
Thaxville	\$20.00		\$20.00		\$20.00	100	no	yes		5 days	\$25.00			flat fee	
Thibault	\$30.50	\$19.50	\$41.11	\$53.24	\$94.35	162	no	yes		60 days	\$25.00	\$750.00		flat fee	
Thomson	\$27.20		\$26.10	\$14.70	\$40.80	235	yes	yes	\$80.00	10 days	\$100.00	\$600.00		flat fee	
Tilden	\$11.00	\$5.00	\$41.36	\$20.18	\$61.54	543	no	yes	\$100	45 days		\$250.00		flat fee	For road crossing all the jobs will have water shutoff installed. We do not provide anything on site services. If a meter needs installed or repaired, we hire a plumber to do it and also provide the cost unless the meter repair was caused by some other party. The plumber will provide the cost for the meter. The cost for the meter is \$121.60. 16,000 gallons for the quarter cost \$184.80
Timber Ridge	\$100.00		\$121.60		\$121.60	36	no	yes		61 days	\$650.00			flat fee	
Tracy Park	\$30.94	\$7.19	\$36.60	\$6.84	\$43.44	246	yes	yes		50 days	\$25.00			flat fee	
Tonica	\$19.00	\$19.00	\$25.70	\$25.70	\$51.40	340	yes	yes		60 days	\$250.00			flat fee	
Toulon	\$16.00	\$17.10	\$32.20	\$26.90	\$59.10	541	no	yes		39 days	\$50.00	\$350.00		flat fee	For road crossing customer must hire a contractor.
Tower Lakes	\$135.75		\$150.75		\$150.75	392	no	yes	\$135.75	45 days	\$150.00			flat fee	

Minimum Water and Sewer Bill

Water Sewer

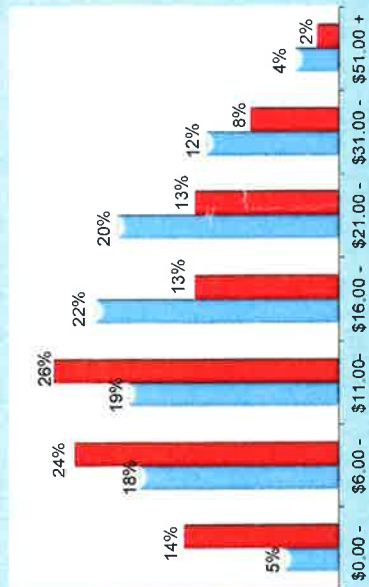

Do you disconnect water for non-payment?

No Yes



What is your reconnect charge after non-payment?

Percent

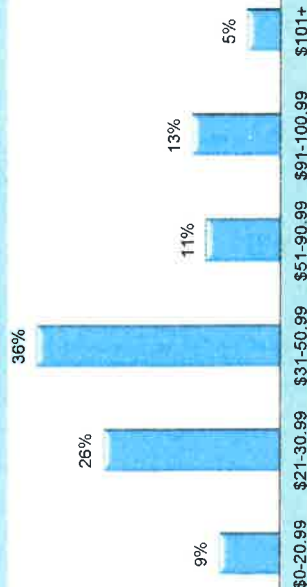

Water and Sewer Bill for 6,000 Gallons

Water Sewer

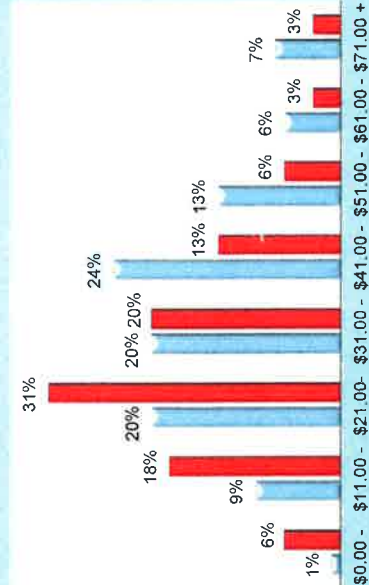

Before disconnection, what is the amount of the outstanding bill?

Percent

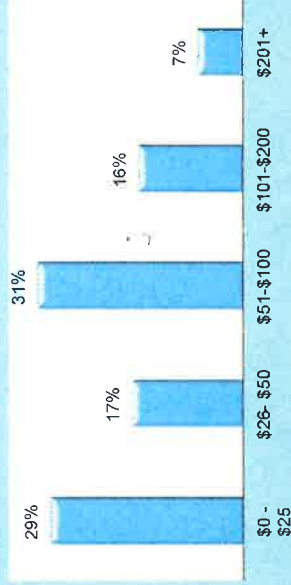

What do you charge for a 3/4 inch water meter tap?

Short tap Bore Road Crossing

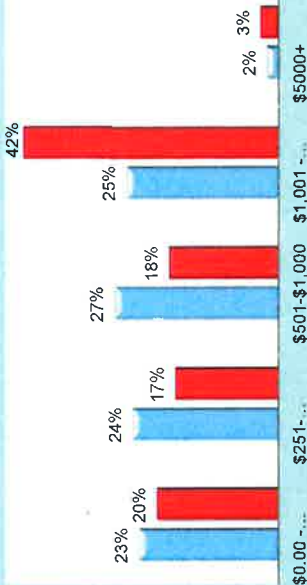

Is a future rate increase expected?

No Yes Maybe

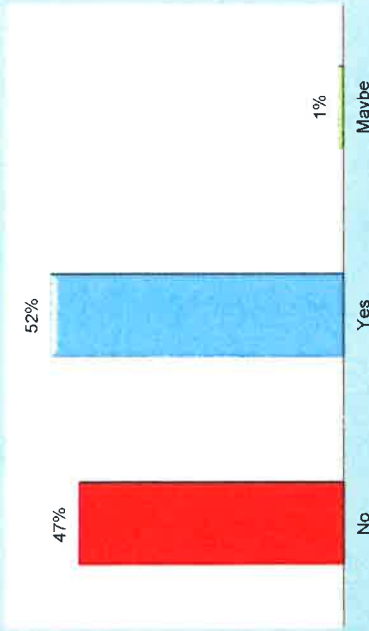

Before disconnection, what do you allow for days outstanding?

Days

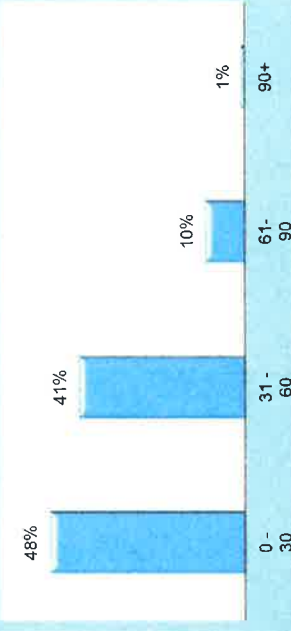

For a meter tap, do you charge rates by a flat fee or by time and materials?

Flat fee T and M No Response

